



Cross Keys Estates

Opening doors to your future



317 Saltash Road
Plymouth, PL2 2DH
Guide Price £250,000 Freehold



317 Saltash Road, Plymouth, PL2 2DH

Guide Price £250,000 Freehold

** Guide Price £250,000 to £270,000 **

Cross Keys Estates is pleased to present this charming end terrace house located on Saltash Road in the highly sought-after area of Keyham. This delightful property, offers a perfect blend of character and modern living, making it an ideal home for families or professionals alike.

Upon entering, you will be welcomed by a spacious open plan sitting room and dining room, providing a warm and inviting atmosphere for both relaxation and entertaining. The modern, stylish fitted kitchen is a highlight of the home, designed to meet the needs of contemporary living while maintaining a sense of charm.

The property boasts three generously sized double bedrooms, ensuring ample space for family members or guests. The convenient utility room adds to the practicality of the home,

- Spacious Extended End Terrace
- Highly Popular Residential Area
- Private Front & Rear Garden
- 3 Spacious Double Bedrooms
- Convenient Utility Room
- Open Plan Sitting Room/Dining Room
- Sleek Modern Fitted Kitchen
- Allocated Off-Road Parking
- Close To Amenities & Schools
- Early Viewing Advised, EPC=D65



Cross Keys Estates

As one of Plymouth's leading QUALIFIED estate agents for over two decades, we are proud to have been offering our multi award winning customer service since day one. If you are currently on the market or you are thinking of putting your property on the market, why not give us a call, you will not be disappointed. 98% of our clients recommend us to their friends and family and our results, when it comes to sales, are unrivalled.

Plymouth

Plymouth, Britain's Ocean City, is one of Europe's most vibrant waterfront cities. Located in one of the most beautiful locations imaginable, Plymouth is sandwiched between the incredible South West coastline and the wild beauty of Dartmoor National Park. Plymouth is 37 miles south-west of Exeter and 190 miles west-south-west of London, between the mouths of the rivers Plym to the east and Tamar to the west where they join Plymouth Sound to form the boundary with Cornwall, it is also home to one of the most natural harbours in the world. To the North of Plymouth is Dartmoor National Park, extending to over 300 square miles, which provides excellent recreational facilities.

The city is home to more than 260,000 people, making it the 30th most populated city in the United Kingdom and the second-largest city in the South West, after Bristol and has a full range of shopping, educational and sporting facilities. There is mainline train service to London (Paddington) and to Penzance in West Cornwall.

There's everything that you would expect to find in a cool, cultural city, with great shopping, arts and entertainment. But there's also hundreds of years of history to uncover, from Sir Francis Drake and the Spanish Armada to the Mayflower sailing in 1620, to a city rebuilt following the Blitz during World War II. With easy access to Exeter and its International Airport and a mainline train station giving direct access to London and a ferry port offering sea crossings to both France and Spain.

Plymouth is governed locally by Plymouth City Council and is represented nationally by three MPs. Plymouth's economy remains strongly influenced by shipbuilding and seafaring including ferry links to Brittany and Spain, but has tended toward a university economy since the early 2000's. It has the largest operational naval base in Western Europe – HMNB Devonport.

Keyham

Keyham is close to the Dockyard making this property ideal for Dockyard workers and is a Victorian/Edwardian built area. It was built to provide dense affordable housing just outside the wall of HM Dockyard Devonport for the thousands of civilian workmen. In the early-19th century, Devonport Dockyard was smaller than now; it was enlarged mid-century by Keyham Steam Yard - Keyham at that period was a suburb of Devonport itself. Keyham Steam Yard was one of the locations for the first trials of the Fairbairn patent crane. The Roman Catholic Church of Our Most Holy Redeemer was built in 1901 but was destroyed by fire following a bombing raid in 1941 and it was rebuilt in 1954. Parts of the southern end are now subject to massive redevelopment using a regeneration package. It has a railway station. Drake Primary School and Keyham Barton Primary Schools, educate 4 - 11-year-olds, with most secondary school children, attending Stoke Community College, Devonport High School for Boys or Marine Academy Plymouth (in King's Tamerton). College students, may attend Goschen Centre, or the Kings Road Centre.

More Property Information

Outside, you will find allocated off-road parking for two vehicles, a valuable feature in this popular residential area. The private front garden offers a lovely space to enjoy the outdoors, perfect for those sunny days.

Situated close to local amenities, this property provides easy access to shops, schools, and transport links, making it an excellent choice for those seeking convenience and community. With its spacious layout and desirable location, this end terrace house is a wonderful opportunity not to be missed. We invite you to arrange a viewing and experience all that this lovely home has to offer.

Entrance Vestibule

Hallway

Fitted Kitchen

13'0" x 8'1" (3.96 x 2.46)

Sitting Room

13'3" x 12'11" max (4.04 x 3.94 max)

Dining Room

12'11" x 11'8" (3.94 x 3.56)

Utility Room

9'3" x 6'2" (2.82 x 1.88)

Landing

Primary Bedroom

12'8" x 11'4" (3.86 x 3.45)

Bedroom 2

12'9" x 11'8" (3.89 x 3.56)

Bedroom 3

15'4" x 12'8" max (4.67 x 3.86 max)

Family Bathroom

Separate Toilet

Garden

Parking

Cross Keys Estates Lettings Department

Cross Keys Estates also offer a professional, ARLA accredited Lettings and Management Service. If you are considering renting your property in order to purchase, are looking at buy to let or would like a free review of your current portfolio then please call our director Jack who is a fully qualified and award-winning letting agent on 01752 500018

Financial Services

Cross Keys Estates are proud to work in partnership with Peter Nixon Financial Services, our whole of market mortgage specialists. With over 18 years industry experience, they are able to source the very best deal to meet their customers circumstances. Offering professional and friendly advice on residential and investment mortgages. Please get in touch to arrange a free, no obligation appointment to see how they can help you. Tel. 01752 255905, Email. sarah.millman@pn-fs.co.uk



Ground Floor

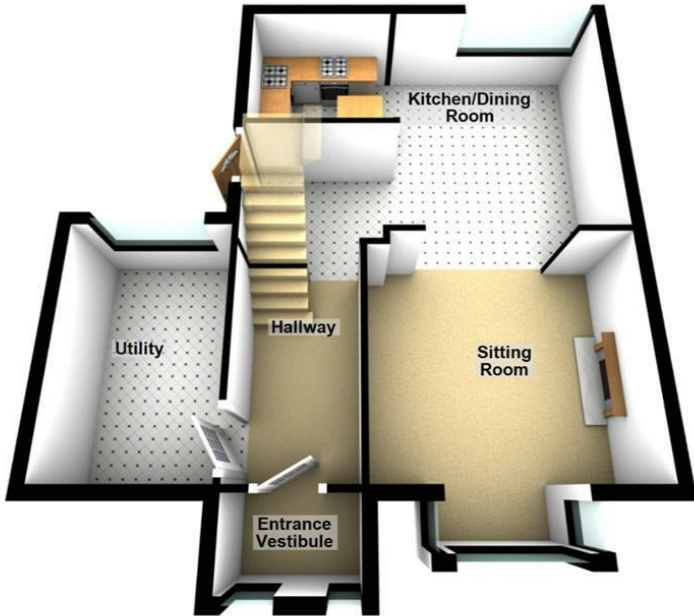

First Floor

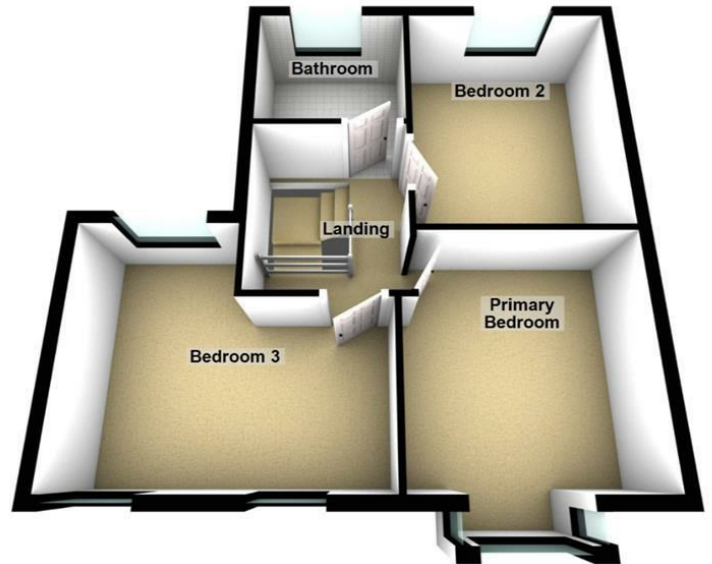

Cross Keys Estates
 Residential Sales & Lettings

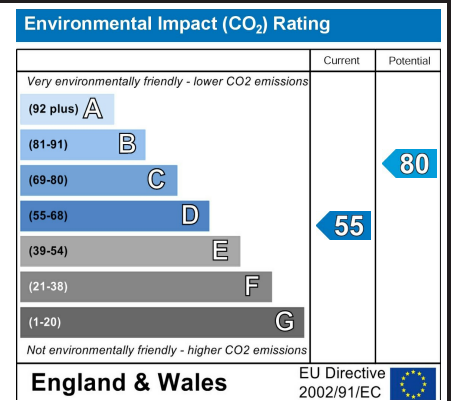
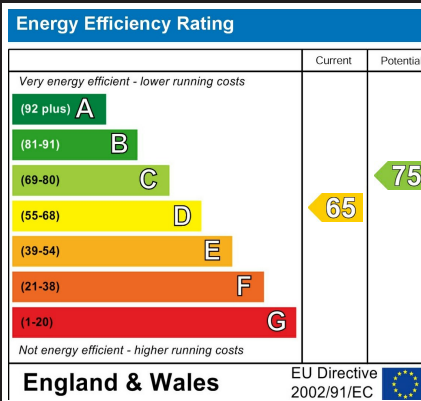
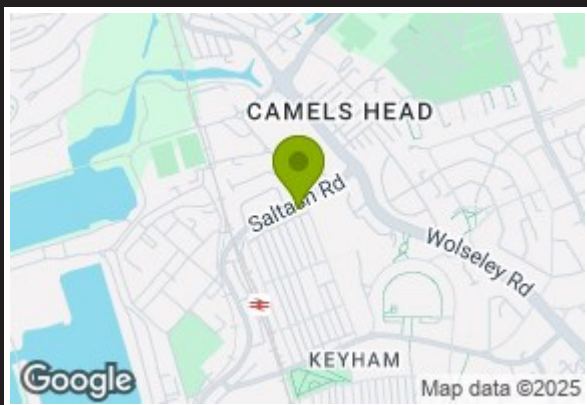

VIEWINGS AND NEGOTIATIONS Strictly through the vendors agents, Cross Keys Estates MONEY LAUNDERING REGULATION 2003 AND PROCEEDS OF CRIME ACT 2002 Cross Keys Estates are fully committed to complying with The Money Laundering Regulations that have been introduced by the government. These regulations apply to everyone buying or selling a property, including companies, businesses and individuals within the United Kingdom or abroad. Should you either purchase or sell a property through this estate agents we will ask for information from you regarding your identity and proof of residence. We would ask for you to co-operate fully to ensure there is no delay in the sales/purchase process. IMPORTANT: we would like to inform prospective purchasers that these sales particulars have been prepared as a general guide only. A detailed survey has not been carried out, nor the services, appliances and fittings tested. Room sizes should not be relied upon for furnishing purposes and are approximate. If floor plans are included, they are for guidance only and illustration purposes only and may not be to scale. If there are any important matters likely to affect your decision to buy, please contact us before viewing the property.



Council Tax Band B



Cross Keys Estates
 Opening doors to your future

Sales, Cross Keys House 51-53 Devonport Road,,
 Stoke, Plymouth, Devon, PL3 4DL
 Tel: 01752 500018 | sales@crosskeysestates.net
 www.crosskeysestates.net